

APSKY QUAD-COPTER FLIGHT MANUAL

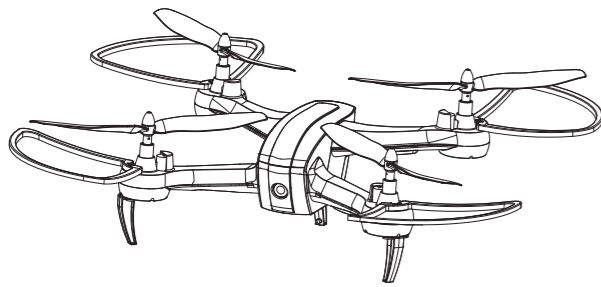

Battery requirements for transmitter:
4 X 1.5V "AAA" size batteries (not included)
QUAD-COPTER is equipped with a Li-Poly rechargeable battery,
please also pay attention to the following safety precautions:

Safety Precautions

- * Please read through the manual before using
- * Don't use or leave the battery near a heat source such as fire or heater
- * Never throw any batteries in a fire
- * Don't strike or throw the battery against any hard surface
- * Don't immerse the battery in water, and keep the battery in a cool dry place
- * When recharging, only use the battery charger intended for that purpose
- * Don't over-charge the battery
- * Never leave the QUAD-COPTER or battery unattended during battery charging
- * Never charge the battery for more than one hour
- * Never fly the QUAD-COPTER near other people
- * Keep all body parts away from the copter while the rotor blades are spinning
- * Please store small parts in a place well out of the reach of small children
- * Observe all Laws regarding flying a drone in your state

-1-

What's in the box

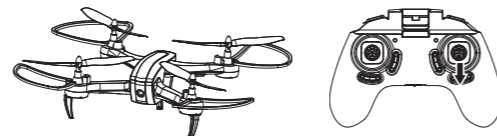

Quad-copter, transmitter, 4 replacement main blades, blade protectors, rechargeable battery, & USB battery charging cable

Installing blade protection frames

1. Install the blade protecting frame to every corner by gently pressing into slots.
2. Press release clip on quad-copter to remove blades

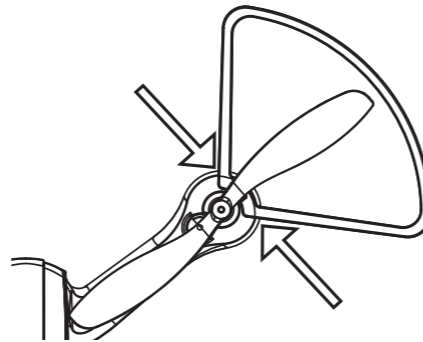

Quad-copter blades

Replacing Damaged blades:
Your QUAD-COPTER will come with 4 replacement rotors, two (A) type and two (B) type. You will see the "A" and "B" word on the canopy, put the rotor on the motor accordingly.

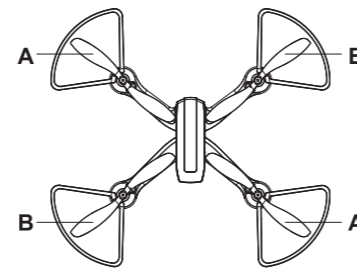

-2-

Installing the battery & camera

1. Open battery cover on the quad-copter and attach battery (Figure 1) lifting upwards
2. Attach battery cable to connector (Figure 2)
3. Once battery connected close cover (Figure 3)
4. Turn quad-copter on/off via button underneath quad-copter (Figure 4)

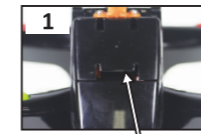

Battery cover lift to open

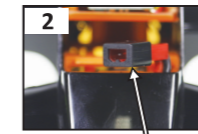

Battery connection

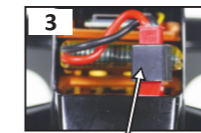

Battery connected

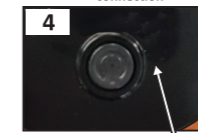

ON/OFF switch underneath quad-copter

Flying Precautions

1. The QUAD-COPTER is powerful, when taking off, move the throttle stick forward gradually, to avoid rising too fast.
2. After flight, turn off the QUAD-COPTER first, then turn off the controller.
3. Note, to avoid injury or damage, the QUAD-COPTER should not be flown nearer than 2 meters from people or other obstacles.
4. Children should fly the QUAD-COPTER under adult supervision only. Always keep the QUAD-COPTER in clear sight while flying.
5. Always turn the power off on the controller and QUAD-COPTER when not in use.

Battery Protection

1. The QUAD-COPTER is equipped with low-voltage protection: When it's battery is low, the programmed control system will stop electrical supply to the QUAD-COPTER's rotors. The battery then needs charging to allow the QUAD-COPTER to fly again.

-3-

Battery Installation

Controller

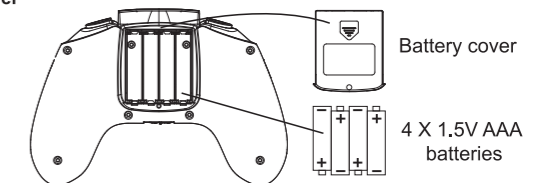

1. To install batteries: Open the cover of the battery case, insert 4 X 1.5V AAA batteries, according to indicated polarity (batteries not included).

Battery installation should be done under adult supervision only!
Do not mix old and new batteries.
Do not mix different types of batteries.

Charging

1. Insert one side of the USB connector into the battery, and the other side into any computer USB port.



Controller

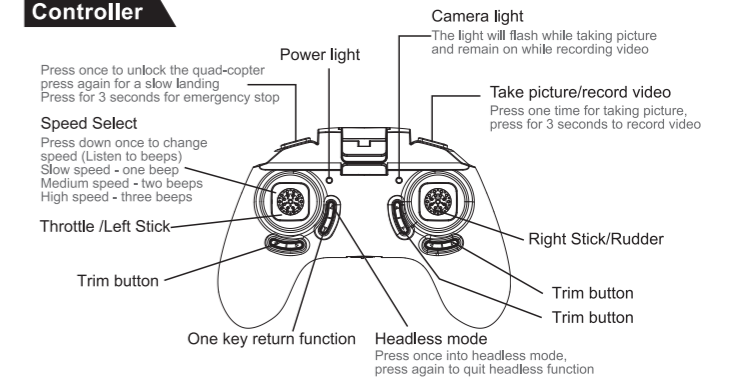

-4-

Connecting to the Quad-copter

1. Power on the QUAD-COPTER and place it on a flat surface
2. Turn on the remote control
3. Push the left stick up to top position then pull it down, a beep sounds and the LED stops flashing, the drone has been unlocked
4. Push the left stick to left (45 degree angle) and right stick to right (45 degree angle) at the same time, motors start rotating, ready to fly
5. Push up the left stick, the QUAD-COPTER takes off and ascends manually.
6. Or press the button "Take off", the drone takes off and ascends automatically
7. Release the throttle, the left stick backs to central position, and QUAD-COPTER hovers automatically

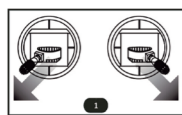

Starting motors

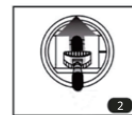

Pushing up

Operation and Control

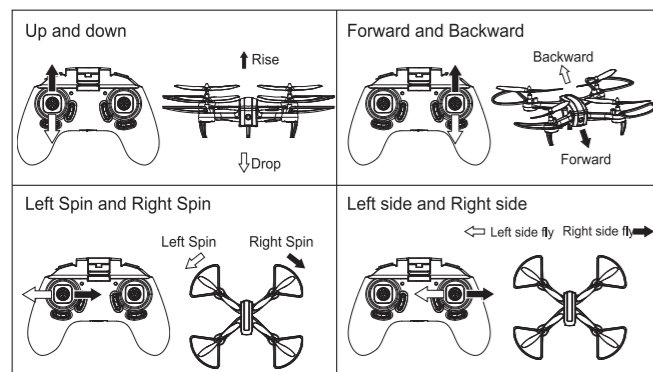

Note: When the QUAD-COPTER is flying towards you, the control directions are reversed.

-5-

Trim fine tuning

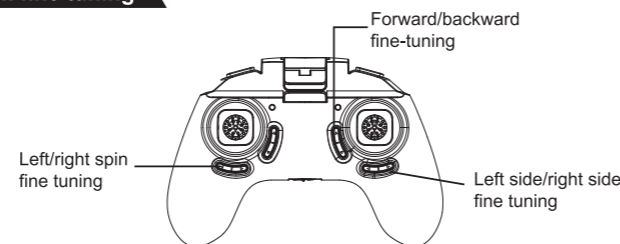

Backward Trim	← Forward	← →	Backward Trimmer
Forward Trim	Backward →	← →	Forward Trimmer
Left side Trim	← →	← →	Left-side trimmer
Right side Trim	← →	← →	Right-side trimmer
Left spin Trim	↻	↻	Left Spin trimmer
Right spin Trim	↻	↻	Right Spin trimmer

-6-

Auto trim function

Press the throttle and rudder down to 45 degree angle (as above) for 10 second, you will see the light on the PC board of quad-copter flashing rapidly, then let go of the throttle and rudder, the light on the PC board remains on, the auto trim finishes.

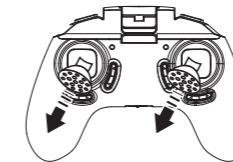

One key return function

When the quad-copter is taking off, the LED lights on the quad-copter stop flashing, at the moment, the quad-copter sets its front side to be the front direction for one key return flying. If you want to reset the front direction, then you need to turn off the rc quad-copter and reset it again.

Press the button as picture shows for one key back home function, and then control right stick (Rudder) to every direction to quit this function.

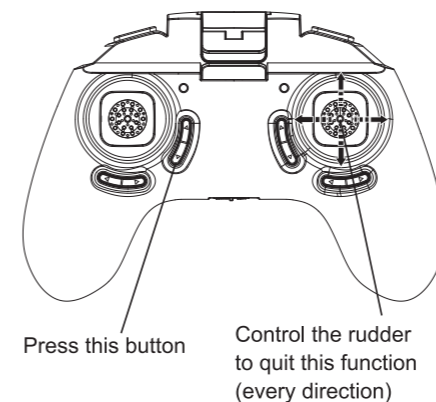

-7-

Headless function:

HOW TO GET INTO/QUIT HEADLESS FUNCTION FLYING?
Press the button on controller (as picture shows) and you will hear beep sounds then you get into compass mode flying. To quit from compass mode, just press it again and you will hear beep sound disappears.

HOW TO RECOGNIZE THE " FORWARD SIDE" UNDER HEADLESS FUNCTION?
When the quad-copter is taking off, the LED light on the quad-copter stop flashing, at the moment, the quad-copter sets its front side to be the front direction for headless mode flying.

If you want to reset the front direction, then you need to turn off the rc quad-copter and reset it again.

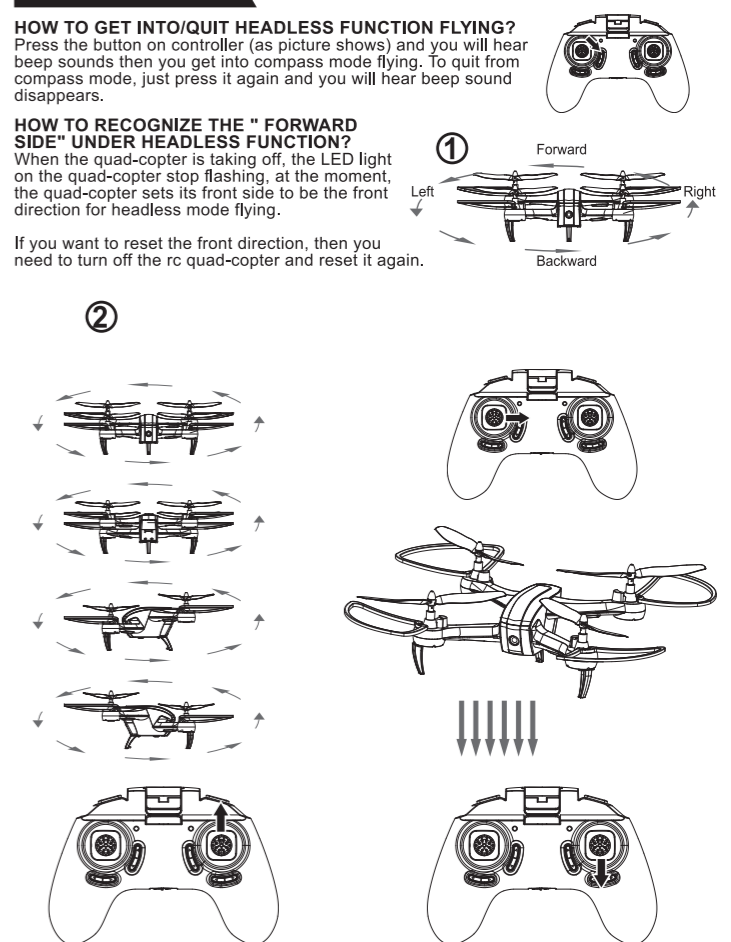

-8-